

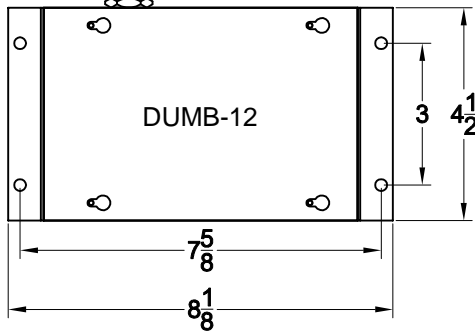

DUMB-XX

Ver. 6 Rel. 12/11/2013

18" GREENFIELD
 8 FEET OF 18 GAUGE WIRE

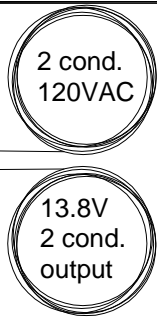

18" GREENFIELD
 8 FEET OF 18 GAUGE WIRE

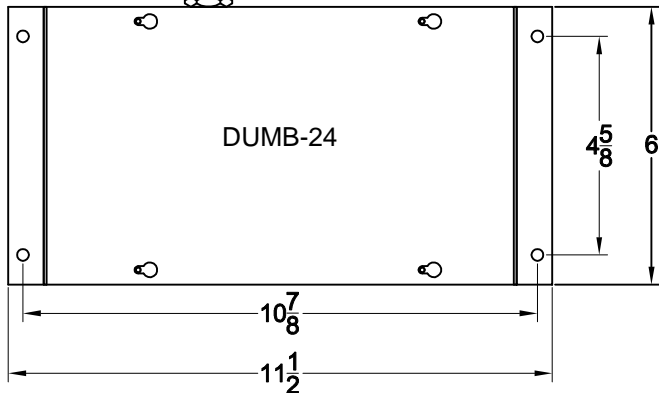
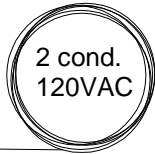

ELEVATOR CAB LIGHTING

The D.U.M.B series Low Voltage LED Lighting System was designed to be retrofitted into existing Cab Lighting that originally used incandescent bulbs. The system allows the existing fixture to have a warm white low voltage LED lamp.

Features:

- Low voltage lighting
- Warm white 3W LED lamp with an Edison Screw Base Lamps uses DL24010031 3W, WW LED Lamp on -12 Series 13.8V
- Power Efficient
- Reduced Cab Heat
- Easy Installation
- Complete Installation Kit
-  E221238

TO ORDER:-SPECIFY DUMB - X X

"12" = 13.8V
 "24" = 27.6V